

# Cakewalk

A Recipe for Streamlined Classroom Design & Management



# Agenda

- Introduction
- Learning Space Design
- Brainstorming Activity
- Room Types
- Cakebook
- Benefits
- Use Cases

# Introduction

Joshua Gaul

SUNY Empire State College

Saratoga Springs, NY

Director of Educational & Emerging Technologies

# Learning Space Design

- Learning Space Design as a science
- Malcolm Brown - EDUCAUSE
- <https://www.educause.edu/-/media/files/educause/eli/initiatives/lrsrv2.pdf?la=en&hash=1AD5E1510B12B1D688D4483283931F73B8316257>

# Learning Space Rating System

- **Integration with Campus Context**
  - Campus Academic Strategy, Learning Space Master Plan, Technology Strategic Plan, Commitment to Evidence-Based Research, Campus Leadership
- **Planning and Design Process**
  - Stakeholder Engagement, Evidence-Based Planning & Design, Pilots/Prototypes, Evaluation Plan, Dissemination of Findings
- **Support and Operations**
  - Support, Orientation & Training, Faculty Development, Financial Sustainability, Scheduling Systems. Diverse Patterns of Use
- **Environmental Quality**
  - Daylight, Visibility to Outdoors, Interior Visibility, Lighting Control, Thermal Comfort, Acoustic Quality, Environmental & Cultural Inclusiveness, Accessibility & Universal Design
- **Layout and Furnishings**
  - Proximities, Movement, Density, Flexibility, Surfaces, Movable Partitions, Comfort, Transparency, Access to Adjacent Spaces, Writable Surfaces, Physical Storage, Future Proofing
- **Technology and Tools**
  - Electrical Power, Network Connectivity, Visual Displays, Sound, A/V Interface & Control, Distributed Interactivity, Session Capture & Access

# Planning Spaces

- Function
- Size & Capacity
- Furnishings
- Technology
- Cost





# Brainstorming Activity

# Standard Room Types

- Classrooms
- Offices
- Conference Rooms
- Computer Labs
- Specialized Rooms



# Room Types @ ESC

- **Offices**
  - Private
  - Shared
  - Mobile
- **Meeting Spaces**
  - Touchdown Rooms
  - Collaboration Spaces
  - TEAL Collaboration Spaces
- **Learning Spaces**
  - Levels 1-3
  - Multipurpose Rooms
- **Labs**
  - Computer Labs
  - Media Labs
- **Innovative Spaces**
  - Active Learning Classrooms
  - Immersive Cloud Learning Source & Destination Rooms

A background network diagram with nodes and connections. The nodes are represented by circles of varying sizes and colors, including orange, blue, red, and yellow. They are interconnected by a web of thin, dark grey lines. Two horizontal green lines cross the image, one above and one below the central text.

# What is the Cakebook?

# Cakebook



Whole Foods Market, Phoenix, AZ (<https://www.tasteofhome.com/article/best-grocery-store-cakes/>)



# Cakebook



**10" Round Cake**  
Serves 16  
500/710 cal per slice



**Two Tier Cake**  
Serves 46  
300 cal per slice



**Three Tier Cake**  
Serves 66  
310 cal per slice



**5" Cake with 10 Cupcakes**  
Serves 16  
350/450 cal per each



**Cookie Cake (Half Sheet)**  
Serves 48  
230 cal per slice



**Half Sheet Cake**  
Serves 48  
200-310 cal per slice

MERMAID

UNICORN



**10" Round Cake**  
Serves 16  
500/710 cal per slice



**Two Tier Cake**  
Serves 46  
300 cal per slice



**Three Tier Cake**  
Serves 66  
310 cal per slice



**5" Cake with 10 Cupcakes**  
Serves 16  
350/450 cal per each



**Cookie Cake (Half Sheet)**  
Serves 48  
230 cal per slice



**Half Sheet Cake**  
Serves 48  
200-310 cal per slice

©2019 DecoPac. **WARNING: CHOKING HAZARD** Small parts. Not for children under 3 years.

©2019 DecoPac.

Sam's Club (<https://catalog.samsclub.com/cakebook/Cake-Book-2019/4/>)

# Cakebook



©2019 DecoPac. **WARNING: CHOKING HAZARD** Small parts. Not for children under 3 years.

BABY SHOWER/1<sup>ST</sup> BIRTHDAY

EDIBLE IMAGE® PRINTED BY PHOTOCAKE®



See your bakery associate for additional cake sizes.

Edible Image  
Printed by PhotoCake

©Disney, ©Warner Bros., ©DC Comics, ©2019 DreamWorks Animation LLC. All Rights Reserved. ©2019 Spin Master Toy Productions Inc. All Rights Reserved. ©2019 Marvel. Created by Stephen Hillenbrand. "Pokemon Party" is a registered trademark of DecoPac. Edible Image® is a registered trademark of The Locks Company, LLC.

**WARNING: CHOKING HAZARD** Small parts. Not for children under 3 years. ©2019 DecoPac

Sam's Club (<https://catalog.samsclub.com/cakebook/Cake-Book-2019/28/>)



# Cakebook

## COLLABORATION SPACE



### FUNCTION

After class spaces for students to do group work for courses Brainstorming sessions for faculty/staff

### TECHNOLOGY

N/A

### FURNISHINGS

Lounge chairs  
Round/Rectangular tables  
Whiteboard(s)

### SUGGESTED CAPACITY

4-8

### NOTES

Allow for BYOD use; power and data, but no integrated technology.

## LARGE MULTIPURPOSE ROOM



### FUNCTION

Space used for lecture-style classes or regional meetings and orientations

### TECHNOLOGY

High-end projector  
Conference phone  
Mersive Solstice  
Room integrated audio system  
Polycom camera system

### FURNISHINGS

Desk chair  
Office chairs  
Stand/sit adjustable podium/desk  
Rectangular/square Table(s)  
Whiteboard(s)

### SUGGESTED CAPACITY

25+

### NOTES

N/A

COST: \$75,000-\$100,000

# Cakebook

## ACTIVE LEARNING CLASSROOM



### FUNCTION

Classroom instruction for active learning courses with more engaging curriculum. Computer-based on-site or web interactive training for faculty/staff

### TECHNOLOGY

Mersive Solstice  
32-inch flatscreens  
65-inch flatscreen  
Switchers

### FURNISHINGS

Office chairs  
Bullet tables  
Skype cameras  
Desk chair  
Sit/stand adjustable podium/desk

### SUGGESTED CAPACITY

15-25

### NOTES

Course must be designed for active learning approach; instructor must have achieved digital fluency certification.

COST: \$45,000-\$60,000

## IMMERSIVE CLOUD LEARNING DESTINATION



### FUNCTION

Space for students to attend classes with an instructor based in ICL Source room or collaborative sessions with ICL destination rooms

### TECHNOLOGY

80-90 inch flatscreens  
Polycom director camera system  
Mersive Solstice  
Room integrated audio system  
Lighting system

### FURNISHINGS

Arch-shaped couch seating  
Coffee table  
Rectangular stool-height tables  
Stools

### SUGGESTED CAPACITY

10-20

### NOTES

Courses delivered must be designed for ICL instruction

COST: \$45,000



## Selden Location

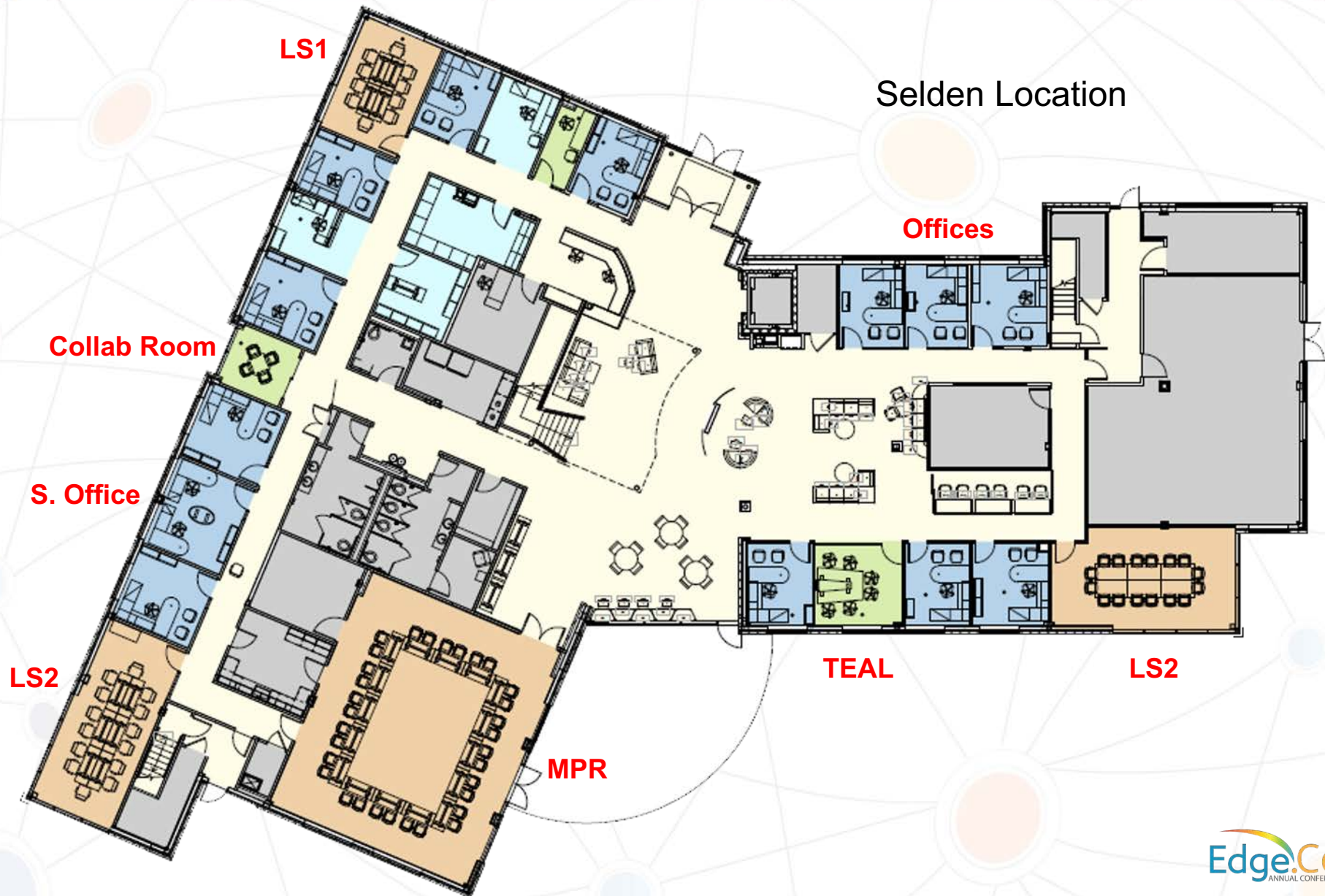

## Selden Location

**ICL  
Destination**

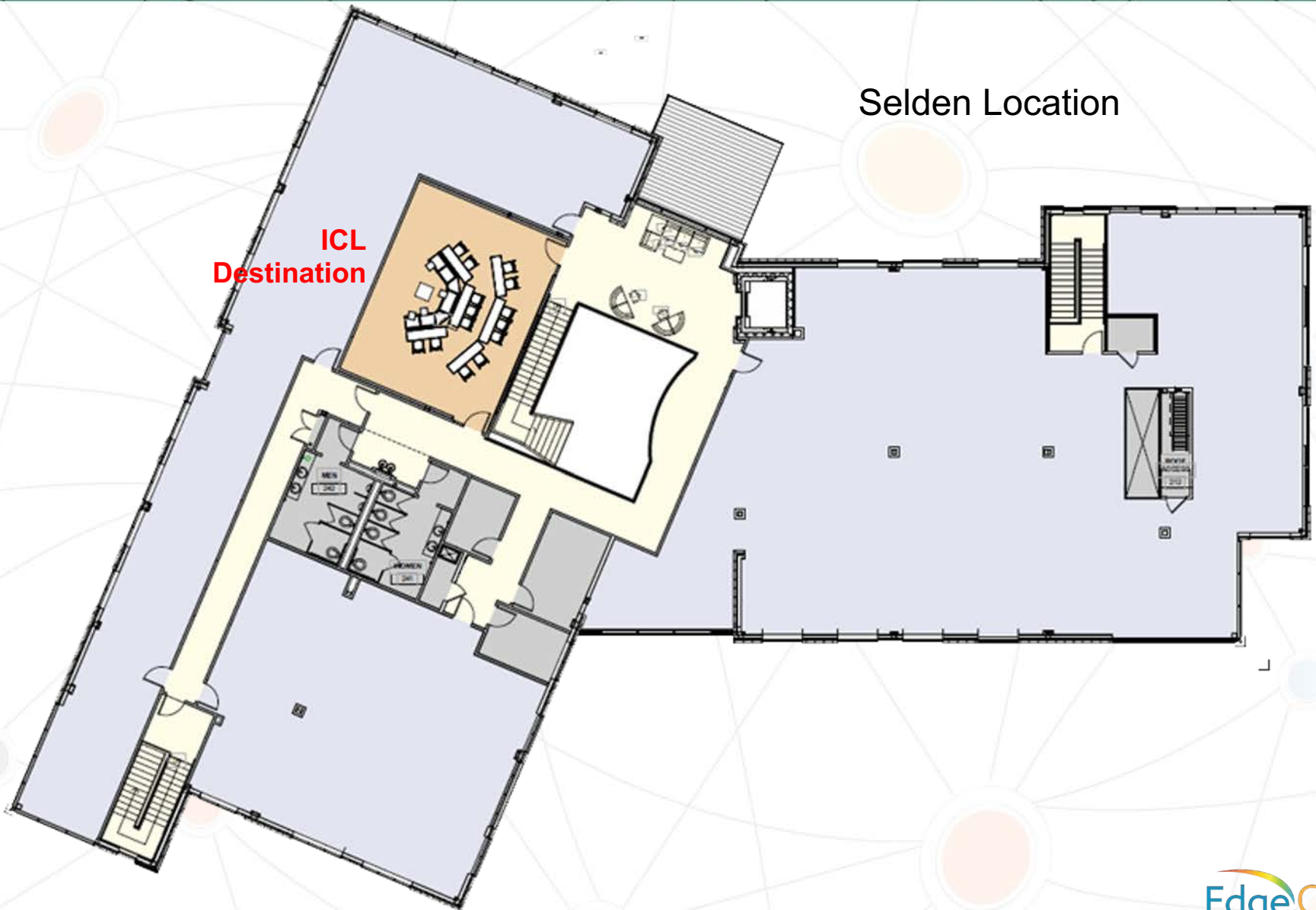

# Cakebook Outcomes

- Cost Estimates
- Branding and Consistency
- Common Language
- Ease of Updates



# Benefits

- Academic Mission
- Facilities Management
- Asset Management
- Procurement

# Use Cases

- University of Cincinnati Space Management

[https://www.uc.edu/af/pdc/space\\_management.html](https://www.uc.edu/af/pdc/space_management.html)

- Purdue University

<https://www.purdue.edu/physicalfacilities/units/asset-management/space-management/index.html>

- University of Minnesota

<https://classroom.umn.edu/>

A complex network diagram serves as the background. It features numerous circular nodes of varying sizes, each filled with a different color including orange, blue, red, yellow, and light blue. These nodes are interconnected by a dense web of thin, dark grey lines. Two prominent horizontal green lines cross the entire width of the image, one positioned above and one below the central text.

Questions?